

Using Your Landing Line



Grab the landing line and pull down. The kite will reverse down to the ground

Wrist Strap Option



The leash can be removed from the chicken loop and a wrist strap can be fitted (as a shown in the photo above). This allows you to practice flying the kite unhooked with the assurance that the safety system can be activated simply by letting go of the bar. This is a useful setup for beginners and first time flyers which takes the fear out of flying.

Care and Maintenance

Taking good care of your Sabre bar will prolong its life

- Always wash your bar out before and after use, paying particular attentions to removing sand from the centre line and clam cleat system
- Rub wax on to your centre line rope to prolong the life of the part.
- Always replace worn ropes before use.
- Always check that your primary (chicken loop) and secondary (leash) release system are fully functional before use.

Safety Guidelines

- Flexifoil strongly recommend that you abide by ALL safety guidelines and conduct yourself in a safe manner at all times
- Seek expert advice from a recognised Flexifoil Dealer, or take lessons from a fully qualified instructor BEFORE undertaking any power and traction activities
- ALWAYS check your equipment for wear and tear before flying. DO NOT fly with worn or damaged equipment. Repair or replace accordingly
- Use EXTREME caution when using kite traction equipment as improper use of this equipment can cause serious injury or death
- ALWAYS select safe launching and landing areas free of people and obstacles. Disable your kite and lines on the ground when not in use
- ALWAYS maintain plenty of space around you in all directions, especially downwind. Traction kites can pull you downwind for a considerable distance
- NEVER attach yourself permanently to your kite or secure yourself to a fixed object whilst flying your kite
- NEVER allow inexperienced kite flyers to use your equipment
- Use appropriate SAFETY equipment i.e helmet, knee and elbow pads, protective eye wear, gloves etc.
- Flying lines and bridles under tension can cut like a knife. Always keep your lines away from people and animals. NEVER attempt to catch or hold a kite by the lines or bridle
- DO NOT fly your kite near power lines, in storms, near airports, roads, railways, people or animals
- Flexifoil kites CANNOT be used for paragliding or parasailing

Warranty

At Flexifoil we believe in designing and manufacturing our products to the highest possible standards. We pride ourselves on our outstanding quality control but if any of our products fail as a result of defective workmanship or faulty materials, we will replace it free of charge. This is in addition to your statutory rights.

Products will not be replaced which have been:

- damaged as a result of normal wear and tear, misuse or neglect
- repaired or modified without the authorisation of Flexifoil International Ltd
- returned to Flexifoil International Ltd without a valid receipt

If you live in the UK, please return faulty products to your local dealer or Flexifoil International. If you live outside the UK please return faulty products to your distributor. A list of dealers and distributors can be found at www.flexifoil.com

Contact Us

Flexifoil International Limited

27 Regal Drive, Soham, Cambridgeshire, CB7 5BE, UK.

tel +44 (0)1353 723131

fax +44 (0)1353 722311

email info@flexifoil.com

web www.flexifoil.com

You can download this manual and any updates in English, French, Spanish and German from www.flexifoil.com

Version 1.0 © FLEXIFOIL INTERNATIONAL LIMITED 2005



Overview

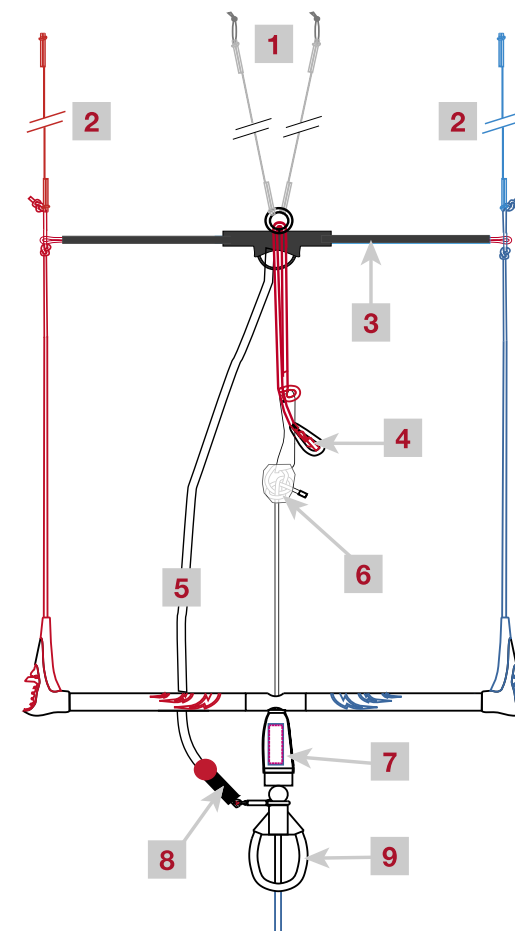

- 1 Front Lines + Toggles
- 2 Rear Flying Lines
- 3 Landing Line with Stake Point
- 4 Clam Cleat and Trim System
- 5 Spinning Leash
- 6 Adjustable Centre Line
- 7 Primary Quick Release
- 8 Secondary Quick Release
- 9 Chicken Loop

Flexifoil strongly recommend that you abide by ALL safety guidelines and conduct yourself in a safe manner at all times (see back panel)

Using Centre Line Depower

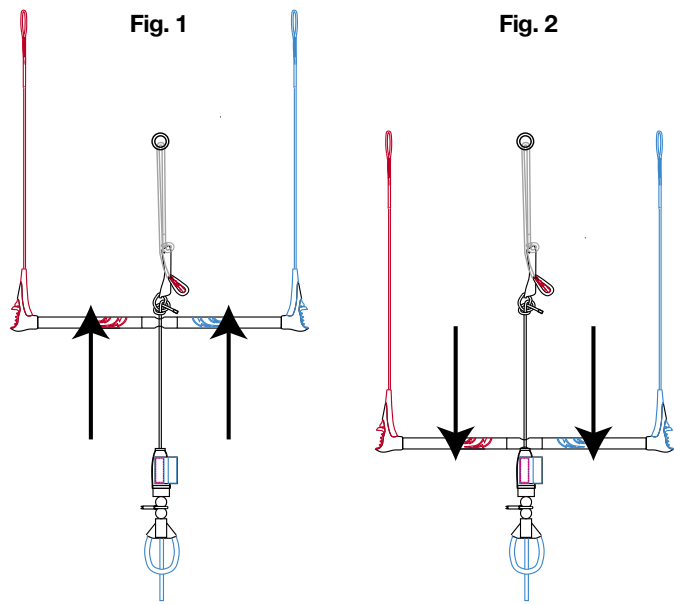

Fig. 1 Pushing the bar away from you reduces the power in the kite.
Fig. 2 Pulling the bar towards you increases the power in the kite

Using the Primary Release



Pull red plastic ball towards your body to activate release system. The kite will reverse down to the ground with no power.

Using the Secondary Release

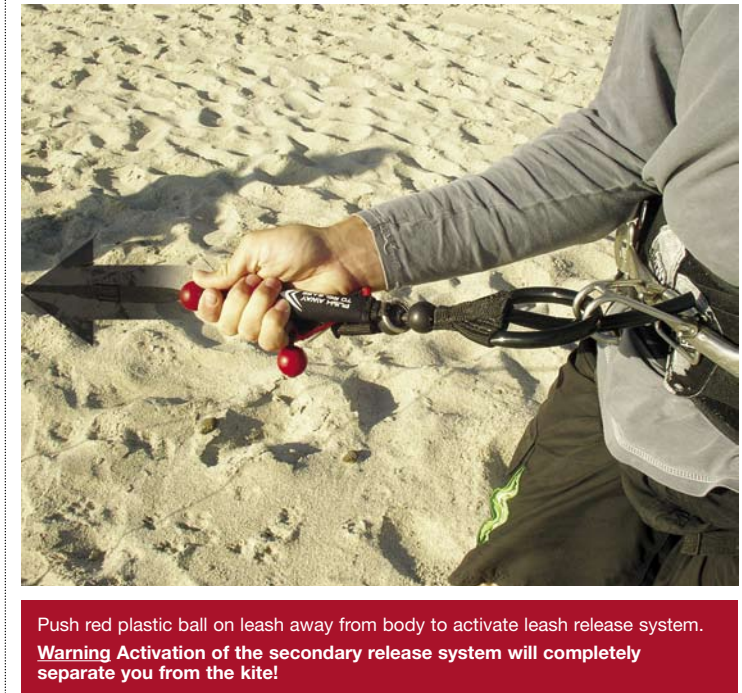

Push red plastic ball on leash away from body to activate leash release system.
Warning Activation of the secondary release system will completely separate you from the kite!

Using Your Clam Cleat

The clam cleat system is used to preset the power of the kite to the riders preference and the wind conditions. You can use the clam cleat to trim the power of the kite and the full power bar position. This increases the wind range and usability of the kite for all riding styles.

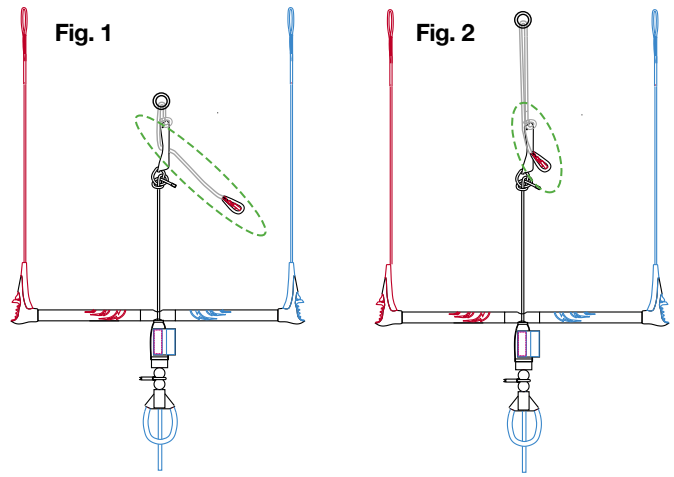

Fig. 1 Pulling the clam cleat rope towards you trims the kite at a more depowered position
Fig. 2 Releasing the clam cleat rope fully trims the kite at a more powered position
Tip: In light wind conditions, use Fig. 2 setup (more powered position)

Reassembling the Primary Release

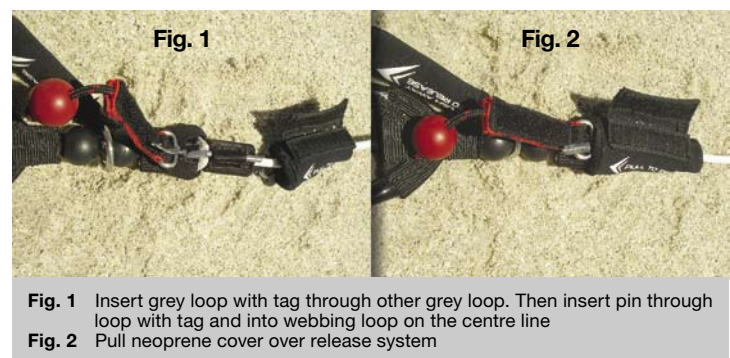

Fig. 1 Insert grey loop with tag through other grey loop. Then insert pin through loop with tag and into webbing loop on the centre line
Fig. 2 Pull neoprene cover over release system



Fig. 3 Velcro red release tag to neoprene cover.
Fig. 4 Secure Velcro flap on neoprene cover to top of red release tag.

Reassembling the Secondary Release

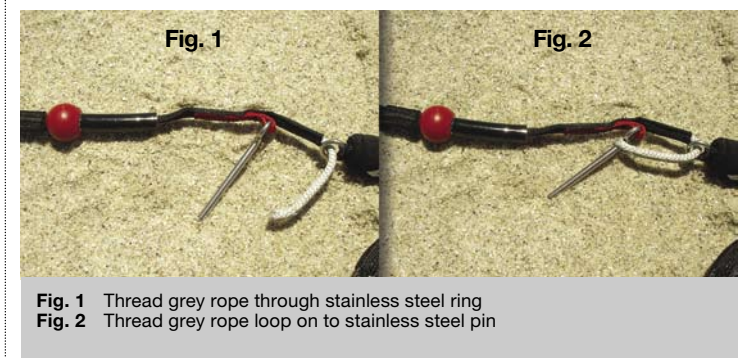

Fig. 1 Thread grey rope through stainless steel ring
Fig. 2 Thread grey rope loop on to stainless steel pin

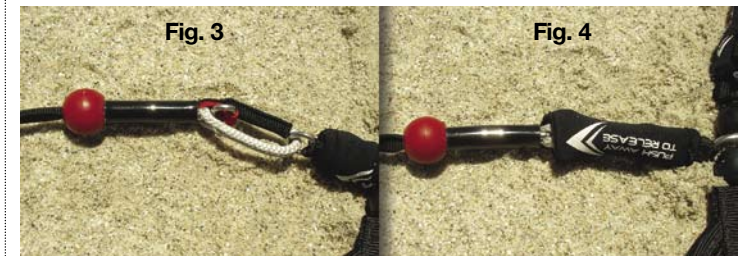

Fig. 3 Pull black tubing cover over the top of the pin
Fig. 4 Cover grey rope with neoprene cover