

INSTRUCTIONS AND SAFETY MANUAL

POWER KITES

STACKER 6 | PROTEAM 8 | SUPER 10



Thank you for purchasing your new **Flexifoil performance power kite**. Before flying your kite, **you should take time to read** and understand these instructions and safety warnings.

Instructions include: safety, wind terminology, overview, setting up, launching, steering, landing and packing away, tuning tips, stacking and care and maintenance.

You can download this manual and any updates from www.flexifoil.com/downloads

SAFETY FIRST

 Flexifoil strongly recommend that you abide by ALL safety guidelines and conduct yourself in a safe manner at all times

Seek expert advice from a recognised Flexifoil Dealer, or take lessons from a fully qualified instructor **BEFORE** undertaking any power and traction activities

NEVER fly your kite in conditions that are too extreme or winds that are too strong for your skill level or your equipment. **ALWAYS** learn to fly with a smaller kite in lighter winds before attempting to fly a larger or more powerful kite in stronger winds

ALWAYS check your equipment for wear and tear before flying. **DO NOT** fly with worn or damaged equipment. Repair or replace accordingly

ALWAYS select safe launching and landing areas free of people and obstacles. Disable your kite and lines on the ground when not in use

ALWAYS maintain plenty of space around you in all directions, especially downwind. Power kites can pull you downwind for a considerable distance

NEVER attach yourself permanently to your kite or secure yourself to a fixed object whilst flying your kite

NEVER allow inexperienced kite flyers to use your equipment

Use appropriate **SAFETY** equipment i.e helmet, knee and elbow pads, protective eyewear, gloves etc.

Flying lines and bridles under tension can cut like a knife. Always keep your lines away from people and animals.

NEVER attempt to catch or hold a kite by the lines or bridle

DO NOT fly your kite near power lines, in storms, near airports, roads, railways, people or animals

Power kites **CANNOT** be used for paragliding or parasailing

 Remember, **YOU** are responsible for the safe operation of your kite and equipment at all times

CHOOSE YOUR FLYING SITE CAREFULLY

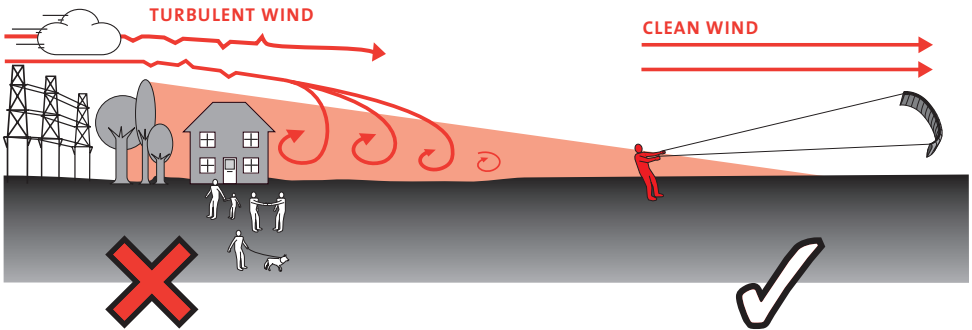

THE WIND WINDOW

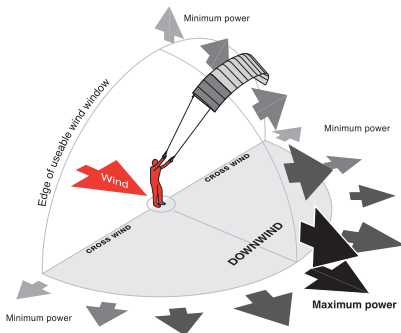

⚠ When launching kites in strong winds, **ALWAYS** launch at the edge of the wind window

WIND SPEED TABLE

FORCE	MPH	KNOTS	KPH	METRES/SEC	Description	ON LAND	THE FLYING EXPERIENCE
0	<1	<1	<1	0-0.2	Calm	Calm; smoke rises vertically	Not enough wind to fly kite
1	1-3	1-3	1-5	0.3-1.5	Light Air	Smoke drift indicates wind direction; vanes do not move	Difficult to fly kite - very low wind
2	4-7	4-6	6-11	1.6-3.3	Light Breeze	Wind felt on face; leaves rustle; vanes begin to move	Good conditions for large kites or beginners
3	8-12	7-10	12-19	3.4-5.4	Gentle Wind	Leaves & small twigs in motion; light flags extended	Ideal flying conditions
4	13-18	11-16	20-29	5.5-7.9	Moderate Wind	Leaves & loose paper raised up; flags flap; small branches move	Ideal flying conditions
5	19-24	17-21	30-38	8.0-10.7	Fresh Wind	Small trees begin to sway; flags flap & ripple	Good conditions for smaller kites or experienced flyers
6	25-31	22-27	39-50	10.8-13.8	Strong Wind	Large branches in motion; whistling heard in wires	Experienced flyers
7	32-38	28-33	51-61	13.9-17.1	Near Gale	Whole trees in motion; resistance felt in walking against wind	Very small kites or very experienced flyers
8	39-46	34-40	62-74	17.2-20.7	Gale	Whole trees in motion; resistance felt in walking against wind (again)	Dangerous winds
9	47-54	41-47	75-86	20.8-24.4	Strong Gale	Slight structural damage occurs; shingles blow from roofs	Do not fly
10	55-63	48-55	87-101	24.5-28.4	Storm	Trees broken/uprooted; considerable structural damage occurs	Do not fly

This table is intended as a rough guide only

⚠ Weather conditions can be unpredictable and can change very quickly. **ALWAYS** be vigilant and respect the power of the wind

POWER KITE PACKAGE INCLUDES



Kite Bag



Kite

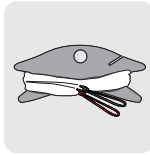

Flying Lines



Spars



Lightweight straps for Stackers 6



Padded straps for Proteam 8 / Super 10

POWER KITE OVERVIEW

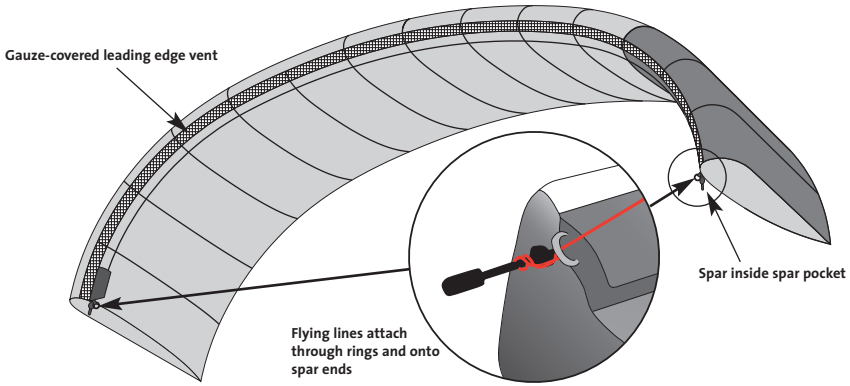

SETTING UP YOUR KITE - SPAR ASSEMBLY

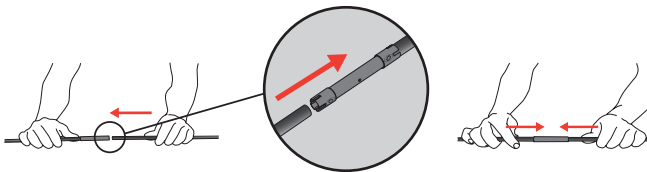

Push spar sections together firmly and slide the spar carefully into the spar pocket. The spar ends will stick out of the spar pocket a little.

UNWINDING YOUR LINES

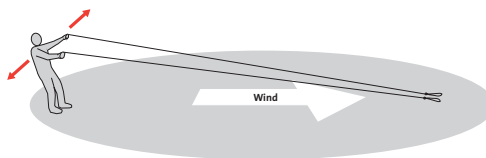

Unwind all of your lines and separate them on the ground. Ensure there are no tangles before connecting.

HOW TO MAKE THE LARKS-HEAD KNOT

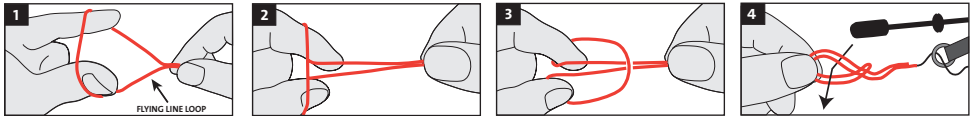

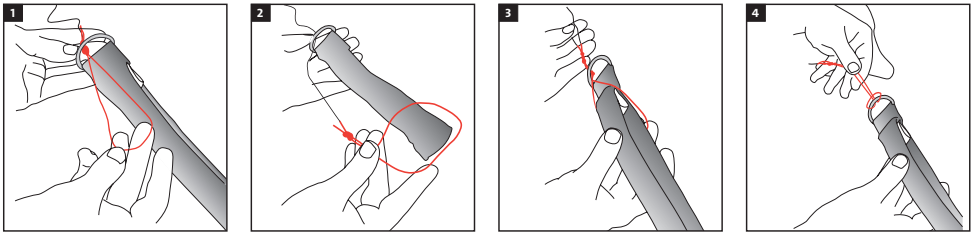

All line to kite connections are made using the larks-head knot. The diagrams above show you how to make one in the loops at the ends of your flying lines.

CONNECTING LINES TO CONTROL GEAR - THE LARKS-HEAD KNOT

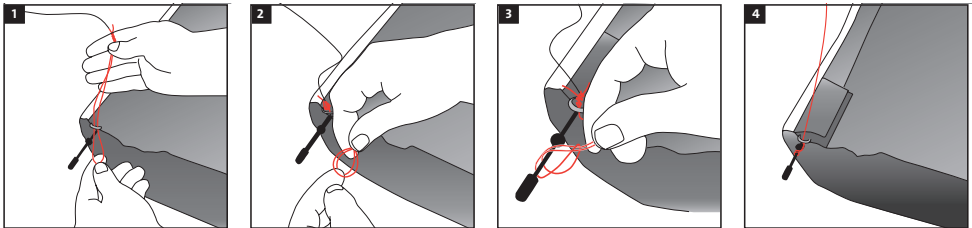

CONNECTING LINES TO THE KITE - THE LARKS-HEAD KNOT



 **DO NOT** attach the flying lines to the rings

SAFE FLYING

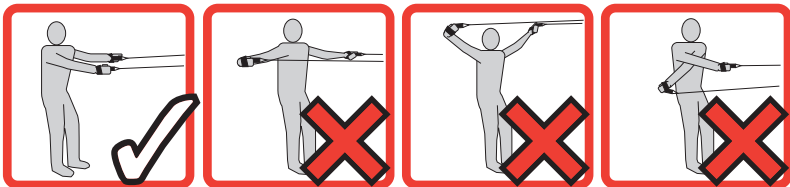

Ensure you have the correct flying position. Ensure your flying lines are unwound completely before launching.

LAUNCHING THE KITE

Please refer to the 'Wind Window' diagram on page 3 for instructions on the area from which to launch your kite.

Assisted Launch

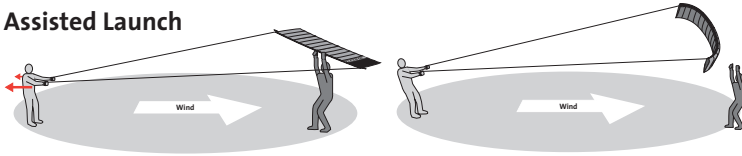

Assisted launch is recommended. Your helper holds the kite in the air, gripping it lightly by the spar. As the kite inflates, pull on the lines and signal to your helper to release the kite without pushing it.

 In light winds you may need to walk back. Look behind you for obstructions!

Solo Launch

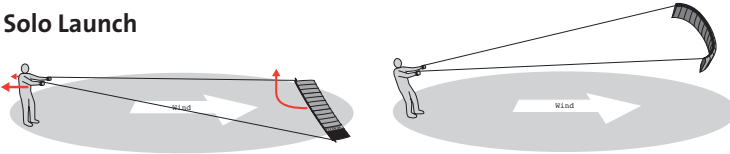

Once you have gained experience solo launching can be practised. However, in long grass or uneven ground solo launching may not be possible.

 NEVER drag your kite across the ground if lift-off is not achieved almost at once. This can cause serious damage. If in doubt, use assisted launch

STEERING THE KITE

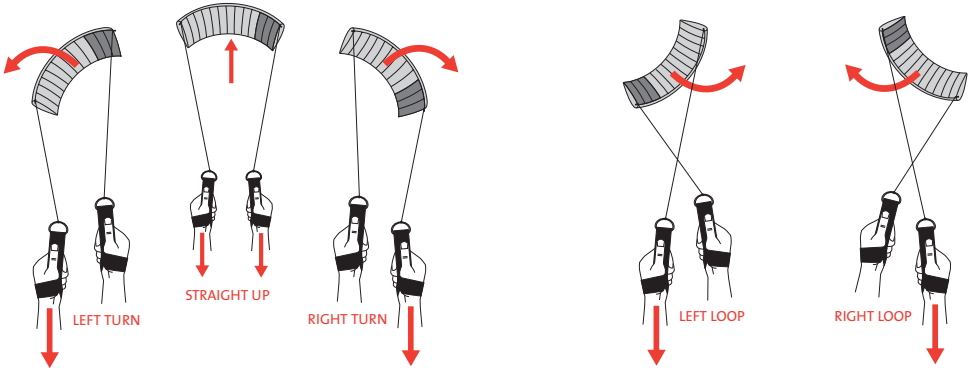

When learning, it is best to make gentle left and right turns at the top of the wind window to get used to your kite. If you fly through the centre of the wind window, the power of the kite will increase significantly and could cause you difficulties. Get confident first and then go for full power!

LANDING AND SECURING YOUR KITE

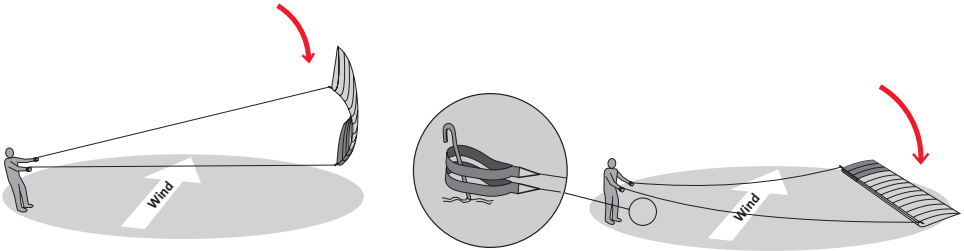

! Do not crash the kite into the ground as this will damage the kite

For a safe landing steer the kite to the edge of the wind window. It will sink gently to the ground. Remember that it usually lands upside down. Secure your kite to the ground by inserting a ground stake through the straps.

! NEVER leave your kite unattended. If you have finished flying, pack it away for safety

PACKING AWAY YOUR KITE

We recommend that you disconnect your lines from your kite and straps. Store your lines on the line winder by winding in a figure-of-eight motion.

IMPORTANT: To avoid twists in the lines, it is vital that the next time you use your kite, you unwind the lines in the same way as you wound them on; i.e. the unwinding action must be the exact reverse of the winding action.

Fold your kite up to spar length. Place the spars on the kite at the trailing edge and roll up towards the gauze. Place carefully in bag.

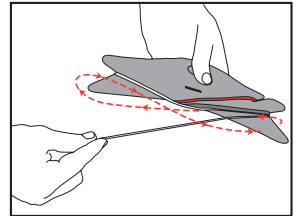

TUNING TIPS / TROUBLESHOOTING

IF THE KITE FLIES CONTINUALLY TO ONE SIDE ... Check that the lines are of equal length. Re-adjust as necessary.

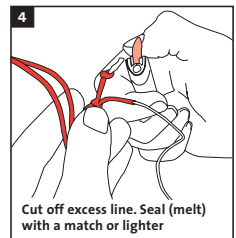
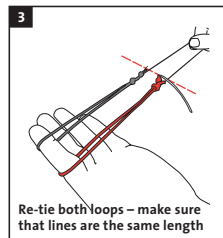
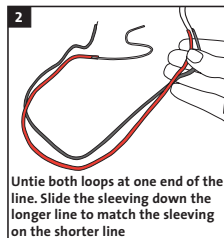
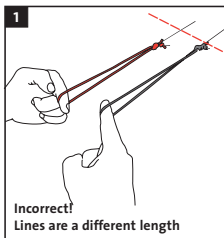

IF THE KITE BOUNCES VIOLENTLY AFTER TAKE-OFF ... There may be sand or water inside. Land safely and remove it. A wet sail surface may also cause bouncing especially on smaller models. Allow to dry before relaunching.

IF THE WINGTIPS FLAP DURING FLIGHT ... Stop flying! You may damage the fabric coating. Check that the lines are not caught around the spar tips.

IF THE KITE IS HESITANT ON TAKE-OFF AND DOES NOT READILY CURVE ... Check that the kite is not wet, or has sand or water inside. If there is insufficient wind or too much wind an assisted launch may be best.

IF THE KITE IS CAUGHT IN A TREE OR OTHER OBSTRUCTION ... Do not pull it violently. Ease each line in turn. If necessary, detach one line from the control strap and retrieve the kite by pulling the other line. Wear gloves to protect your hands.

For more great troubleshooting advice please visit www.flexifoil.com/tips

STACKING

Flexifoil Power Kites are very easy to stack together. Adding another kite of the same size will almost double your power. Different sizes can also be stacked together.

Stacking kits and instructions are available from your Flexifoil dealer or please visit www.flexifoil.com/tips for more information.



CARE AND MAINTENANCE

 Taking good care of your kite will prolong its life

AVOID flying your kite near trees, hedges, stone walls, barbed wire fences or other obstacles that could damage your kite.

DO NOT drag your kite across the ground when trying to launch or land, especially in stubble fields, on stony beaches or on other abrasive surfaces that could damage your kite.

NEVER store your kite wet. Always allow it to dry before packing and storage.

Your kite can be hand-washed with care in warm **NOT HOT** soapy water. Use a mild detergent, i.e. washing up liquid, and a soft sponge.

DO NOT use aggressive detergents or abrasive materials to clean your kite.

DO NOT use a washing machine or tumble dryer!

ALWAYS check your equipment for wear and tear before using it and repair or replace accordingly.

REPAIRS SERVICE

Damaged your kite? Flexifoil kites have been designed to be strong and durable. However, they are not indestructible. If they are crashed hard into the ground or dragged they may get damaged. For this reason we have a repair service available.

ONE MONTH FREE REPAIR OFFER

Power kites are covered by our One Month Free Repair Offer. If you damage your kite within one month of purchase, we will repair it free of charge! Please follow the instructions on the Free Repair Voucher you received with your kite or visit www.flexifoil.com/repairs for more details.

STANDARD REPAIR SERVICE

If you damage your kite when the One Month Free Repair Offer has expired, Flexifoil offer a quick and inexpensive repair service to all its customers. We also stock spare parts and sails for both current and discontinued kites. You can repair small tears with Flexifoil self adhesive repair tape. For larger and more complicated repairs, we recommend that you return your kite to Flexifoil International.

Flexifoil undertake most repairs at their factory but **overseas customers should contact their local distributor for assistance**. Please visit www.flexifoil.com/repairs for the latest information.

WARRANTY

At Flexifoil we believe in designing and manufacturing our products to the highest possible standards. We pride ourselves on our outstanding quality control but if any of our products fail as a result of defective workmanship or faulty materials, we will replace it free of charge. This is in addition to your statutory rights.

Products will not be replaced which have been:

- damaged as a result of normal wear and tear, misuse or neglect
- repaired or modified without the authorisation of Flexifoil International Ltd
- returned to Flexifoil International Ltd without a valid receipt

If you live in the UK, please return faulty products to your local dealer or Flexifoil International. If you live outside the UK please return faulty products to your distributor. A list of dealers and distributors can be found at www.flexifoil.com

SPECIAL NOTE ON FLYING LINES

Flexifoil will not replace flying lines that have been improperly used. If kites are flown on flying lines of insufficient breaking strain, the lines will break. Always follow Flexifoil recommendations to ensure that flying lines of an appropriate breaking strain are used when flying one or more kites. Flexifoil will not replace flying lines that have failed as a result of knots in the line.



FLEXIFOIL®